

17,51 ± 0,2

The distance from the top of front part to the top of active area of sensor

SECTION A-A

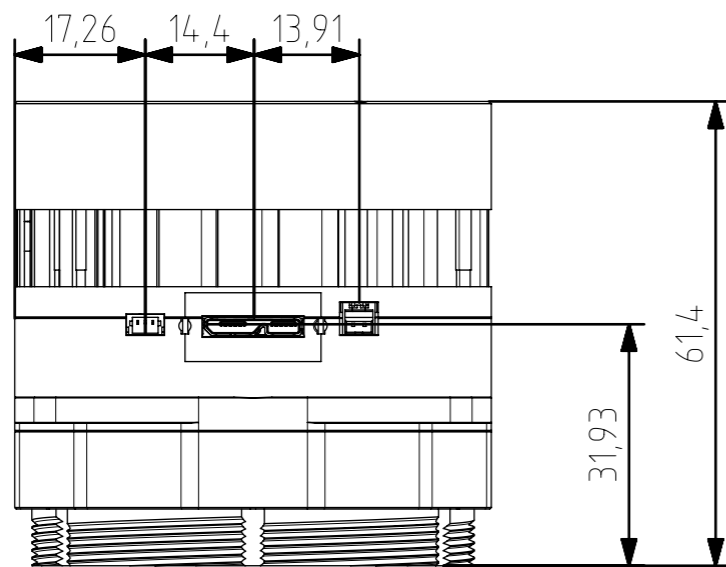
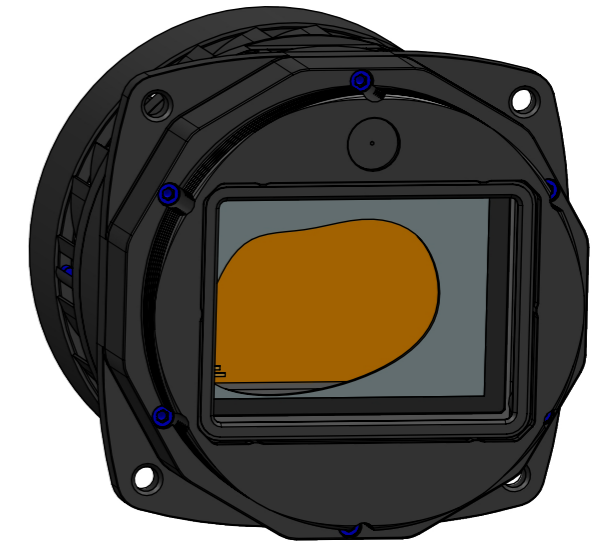
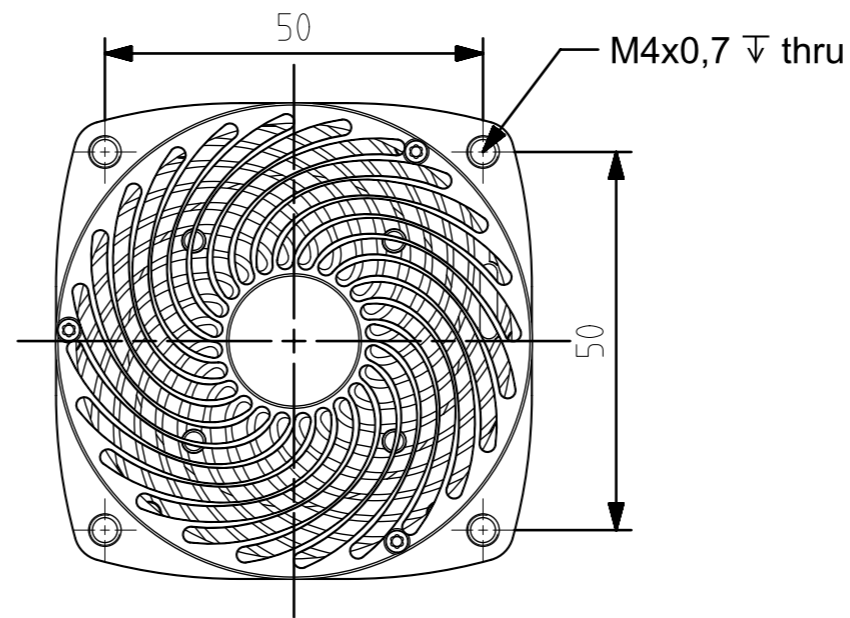
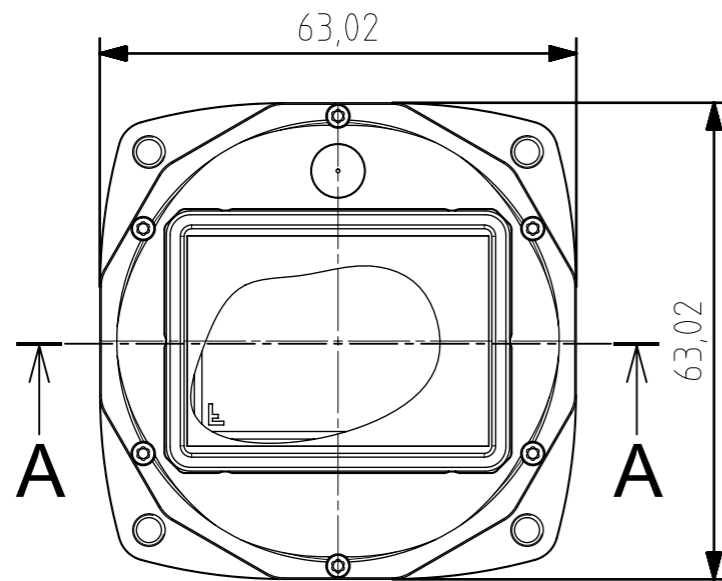

This drawings is the property of XIMEA s.r.o. No use thereof shall be made other than as a reference for proposals as submitted to XIMEA s.r.o. for jobs to be executed in conformity with such proposals unless the consent of said XIMEA s.r.o. has previously been obtained. No part of this drawing shall be copied or duplicated or its contents disclosed. The information contained on this drawing is confidential and proprietary.

Designed	Date: -	Name: S KLIMOVIC	PN: LMR150 (KAI 16070)	Customer PN: NA	Surface Quality:
Drawn	20170906	SPAND	Project Class LMR Top Level Assembly	Material:	Surface Finish: Black Anodized
Approved	20170906	SPAND		First angle projection	Weight:
QC	20170906	SPAND	Department: HADROVNIK	Units: mm	Scale: 1:1
MFGP	20170906	SPAND		Default tolerances: ISO2768-1	Format: A3
ximea			Document Nr:	Doc Type: EU	Part Doc: 1.0
				Version Revision: 1.0	Page: 1 of 1