

SECTION A-A

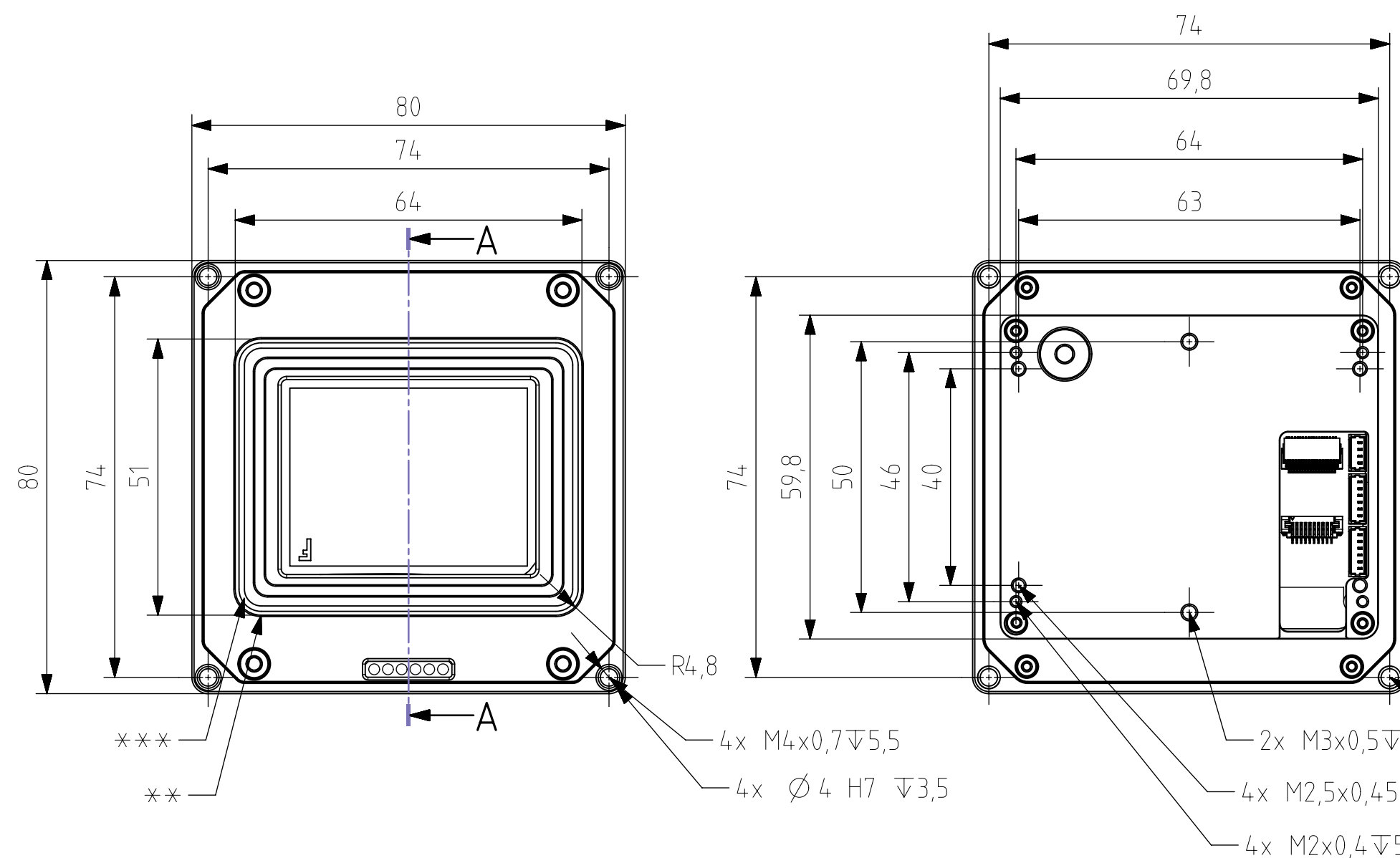

Front and Rear-subassembly separate option

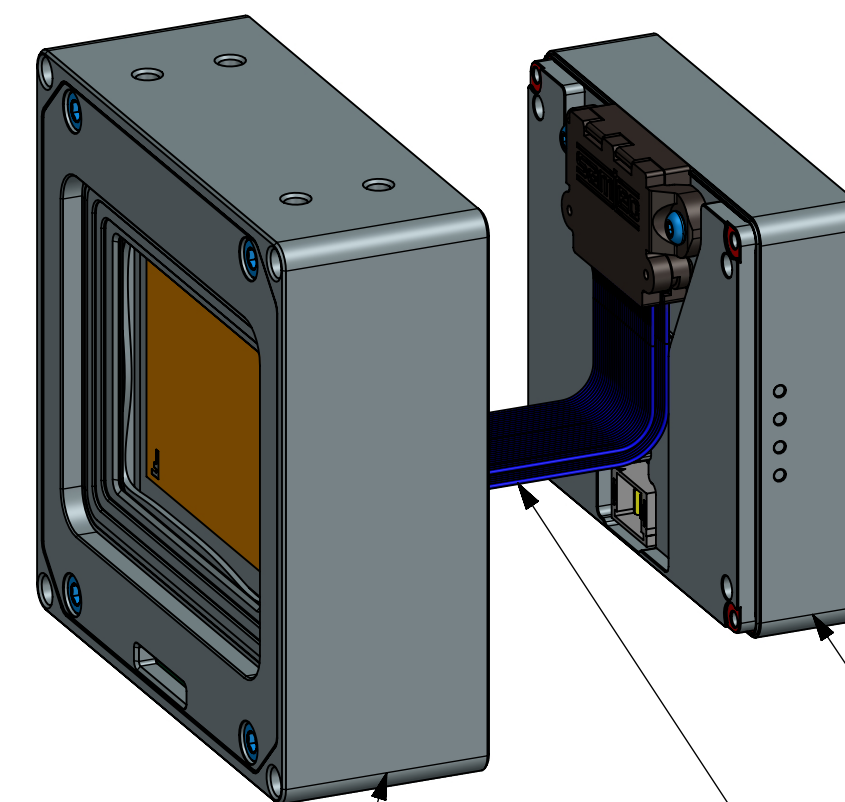

IMX461 front sub-assembly

HQCD-030-STR-TTL 15cm cable

Firefly X4G3 rear sub-assembly

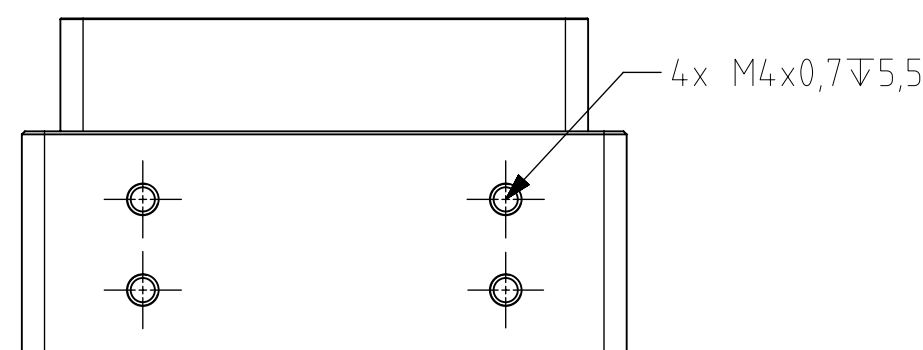

Notes:

- * Active sensor area to camera front area distance
- ** 64x51x3mm (R4,8mm) pocket for filter glass
- *** Small groove for gluing the filter glass

This drawings is the property of XIMEA s.r.o. No use thereof shall be made other than as a reference for proposals as submitted to XIMEA s.r.o. for jobs to be executed in conformity with such proposals unless the consent of said XIMEA s.r.o. has previously been obtained. No part of this drawing shall be copied or duplicated or its contents disclosed. The information contained on this drawing is confidential and proprietary.

	Date:	Name:	PN:	Customer PN:	Surface Quality:
Designed	20210513	R&D	MX1018xR-SY-X4G3-FF	NA	
Drawn	20211108	GS		Material:	Surface Finish:
Approved			PN MFG		optical black
QC					Weight:
MFGP					
Department:	R&D	Default Tolerances:		Units:	Scale: 1:1
				mm	Format
					A2
				Doc Type:	PART REVISION
				EU	A
					Page:
					1 of 1

